

Adaptor Type **KWES/B**

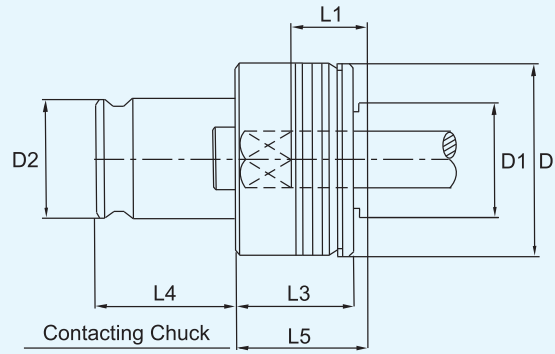

Shank Dia. & Square size of the tap to be specified.

Ordering Example : Adaptor KWES / 2B M20 Dia.14x11.2 = 2 Nos.

Adaptor Designation	For Taps	Shank Ø	Suitable For Chuck Size	D Ø	D1 max. Ø	D2 Ø	L1	L3	L4	L5
KWES/1B	M 3-M 12	3.5-11.3	QCTAH./1	32	19	19	17	25	21.5	25
KWES/2B	M 8-M 20	7.0-18.0	QCTAH./2	50	30	31	30	31	35.0	34
KWES/3B	M 14-M 33	11.0-28.0	QCTAH./3	72	48	48	44	41	55.5	45
KWES/4B	M 22-M 48	18.0-36.0	QCTAH./4	95	60	60	71	61	63.0	68

- ☆ Adaptor Type **QCCCA** : **Q**uick **C**hange **C**ollet **C**huck Adaptor suitable for 'ER' Type Collets.
- ☆ Adaptor Type **QCDCA** : **Q**uick **C**hange **D**rill **C**huck Adaptor suitable for keyless Drill Chucks.
- ☆ Adaptor Type **QCDA** : **Q**uick **C**hange **D**rill Adaptor suitable for Morse Taper Drills.
- ☆ Adaptor Type **QCADA** : **Q**uick **C**hange **A**adjustable **D**rill Adaptor suitable for Morse Taper Drills for pre-setting off the machine, Should be used with adjustable adaptors TR28X2 or TR16X2.
- ☆ Adaptor Type **QCFRH** : **Q**uick **C**hange **F**loating **R**eamer **H**older suitable for Reamers, with self centering radial parallel float.
- ☆ Adaptor Type **QCCD/60** : **Q**uick **C**hange **C**enter **D**ead suitable for Toolroom work.
- ☆ Adaptor Type **QCTAH../..** : **Q**uick **C**hange **T**ap Adaptor **H**ousing suitable for tapping with KWES Tap Adaptors.